



Nice

BiDi Interfaces,

the new series of
devices for the
smart home



BiDi-Switch

Miniaturised unidirectional and bidirectional interface to manage lights and electrical loads.

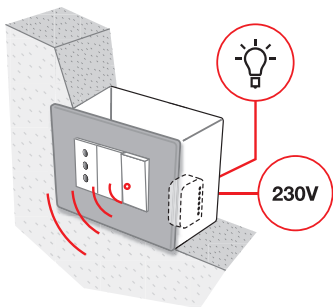

BiDi
Yubii Home

Nice Gateway:

Yubii

Core

MyNice

- BiDi-Switch lets you integrate lights and electrical loads into the smart home system, so you can:**
- Control the connected devices in your home individually, in groups or in scenarios.
 - Control consumption and manage electrical loads, thus reducing energy waste.
 - Receive feedback on device status.
 - Control their functions by creating personalised scenarios, including via the alarm system.
 - Use Amazon Alexa, Google Home and Siri Shortcuts voice commands to turn the connected devices on and off.
 - Manage the devices remotely via smartphone, smartwatch or car infotainment with the Yubii or MyNice apps.

Practical and economical
All the lights in a room can be managed with one device and there's no need to buy smart bulbs or replace the existing switch. Thanks to its small size, BiDi-Switch can be installed in most flush-mounted boxes.

Possibility of timer-regulated automatic switch-off.

Backward compatible
If you replace the TT2L unidirectional control unit with the BiDi-Switch, the transmitter need not be replaced and the connected devices can be turned on and off even without a gateway.

Efficient
Each bidirectional product acts as a radio signal repeater to extend signal coverage.

TECHNICAL SPECIFICATION

Code	Description	Pcs./pack	Certificates
BIDI-SWITCH	Unidirectional and bidirectional interface to manage lights and electrical loads	1	CE

Code	BIDI-SWITCH
ELECTRICAL SPECIFICATIONS	
Power supply (VAC/Hz)	100–240, 50/60
Rated load current (A)	6 A per channel, 9 A combined
Type of load supported	resistive
Radio frequency (Mhz)	433.05–434.04
Max. transmitted power (dBm)	10
Protection class (IP)	20
Operating temperature (°C Min/Max)	0–35
Dimensions (mm)	45 x 36 x 23 h



For lights and electrical loads

BiDi-Dimmer

Miniaturised unidirectional and bidirectional interface to control and dim the light.

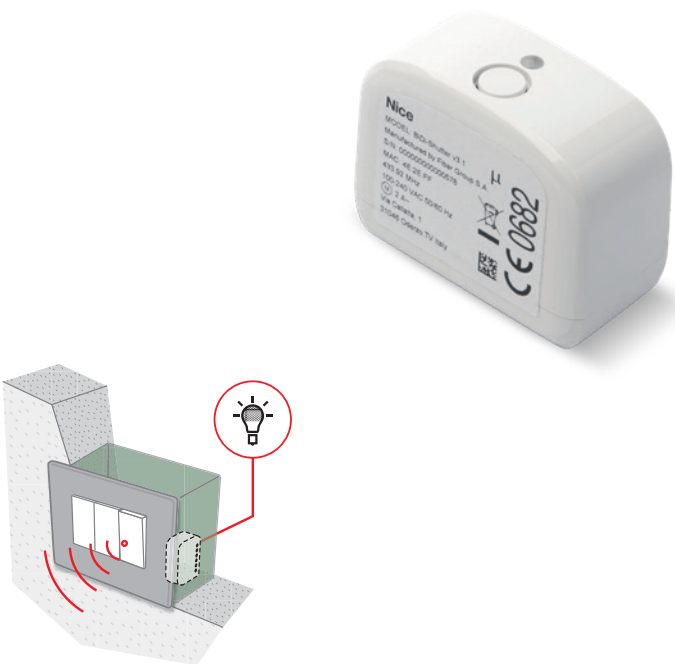

BiDi
Yubii Home

Nice Gateway:

Yubii Core MyNice

BiDi-Dimmer lets you manage the light and integrate it into the smart home system, so you can:

- Control the connected devices in your home individually, in groups or in scenarios.
- Control consumption and manage electrical loads, thus reducing energy waste.
- Receive feedback on automation status.
- Control their functions by creating personalised scenarios, including via the alarm system.
- Use Amazon Alexa, Google Home and Siri Shortcuts voice commands to turn the connected devices on and off.
- Manage the devices remotely via smartphone, smartwatch or car infotainment with the Yubii or MyNice apps.

Practical

- The light can be dimmed via two wired buttons.
- The set brightness level can be recalled from the transmitter.
- It functions by just connecting the “phase”.

Practical

Compatible with various types of bulb: fluorescent, halogen, LED, filament or neon*

Thanks to its small size, BiDi-Dimmer can be installed in most flush-mounted boxes.

Possibility of timer-regulated automatic switch-off.

If you replace the TT2L or TTDMS unidirectional control unit with the BiDi-Dimmer, the transmitter need not be replaced and the connected lights can be managed even without a gateway.

Efficient

Each bidirectional product acts as a radio signal repeater to extend signal coverage.

TECHNICAL SPECIFICATION

Code	Description	Pcs./pack	Certificates
BIDI-DIMMER	Unidirectional and bidirectional interface to control and dim a single light	1	CE

Code	BIDI-DIMMER
ELECTRICAL SPECIFICATIONS	
Power supply (VAC/Hz)	100–240, 50/60
Rated load current (A)	0.25–1.10
- with LED adaptor connected	0.05–1.10
Radio frequency (Mhz)	433.05–434.04
Max. transmitted power (dBm)	10
Protection class (IP)	20
Operating temperature (°C Min/Max)	0–35
Dimensions (mm)	45 x 36 x 23 h

* For some types of LED or energy-saving fluorescent bulbs, an LED adaptor may be required.



BiDi-Shutter

Miniaturised unidirectional and bidirectional multi-purpose interface for indoor blinds, rolling shutters and Venetian blinds.

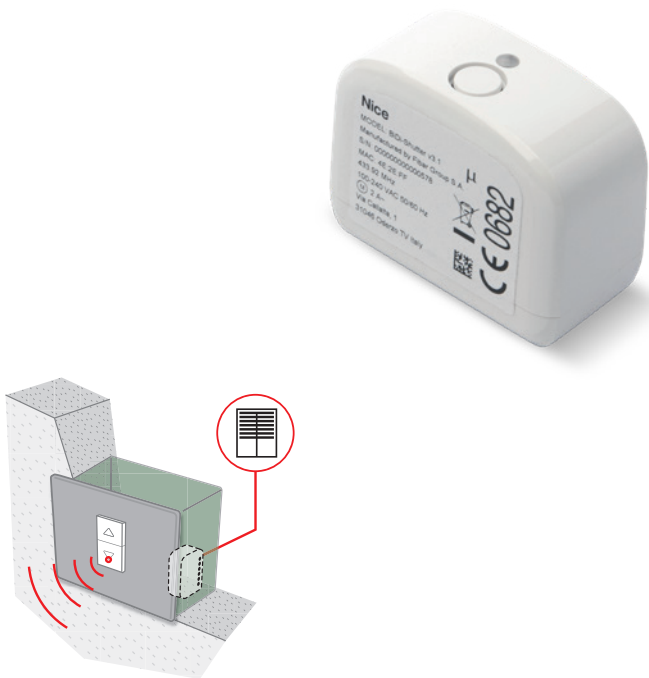

BiDi
Yubii Home

Nice Gateway:

Yubii Core MyNice

With BiDi-Shutter, you can also integrate mechanical tubular motors into the smart home system, so you can:

- Control the connected motors individually, in groups or in scenarios.
- Control consumption and manage electrical loads, thus reducing energy waste.
- Receive feedback on automation status.
- Use Amazon Alexa, Google Home and Siri Shortcuts voice commands to control the connected automations.
- Manage the devices remotely via smartphone, smartwatch or car infotainment with the Yubii or MyNice apps.

Fast programming

The limit switches can also be programmed and adjusted from the transmitter by performing two complete manoeuvres, guaranteeing continuous automatic calibration during operation.

For rolling shutters or Venetian blinds, two intermediate opening positions can be set: the desired position and the position needed to regulate air exchange in the room.

Miniaturised dimensions
BiDi-Shutter can be installed in junction boxes, wall plates or the box near the motor.

Wired input
Can manage a number of tubular motors, including via the wall switch, or be integrated into the Business Management System.

Backward compatible
If you replace the TT2N unidirectional control unit with the BiDi-Switch, the transmitter need not be replaced and the connected devices can be turned on and off even without a gateway.

Efficient
Each bidirectional product acts as a radio signal repeater to extend signal coverage.

TECHNICAL SPECIFICATION

Code	Description	Pcs./pack	Certificates
BIDI-SHUTTER	Unidirectional and bidirectional interface for mechanical tubular motors	1	CE

Code	BIDI-SHUTTER
ELECTRICAL SPECIFICATIONS	
Power supply (VAC/Hz)	100–240, 50/60
Rated load current (A)	2
Type of load supported	single-phase AC
Radio frequency (Mhz)	433.05–434.04
Max. transmitted power (dBm)	10
Protection class (IP)	20
Operating temperature (°C Min/Max)	0–35
Dimensions (mm)	45 x 36 x 23 h



BiDi-Awning

Unidirectional and bidirectional interface for outdoor awnings.

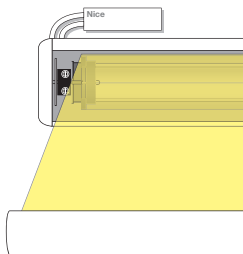

BiDi
Yubii Home

Nice Gateway:

Yubii

Core

MyNice

- BiDi-Awning also lets you integrate the mechanical tubular motors of outdoor awnings into the smart home system:
- Control the connected motors individually, in groups or in scenarios.
 - Receive feedback on automation status.
 - Control consumption and manage electrical loads, thus reducing energy waste.
 - Use Amazon Alexa, Google Home and Siri Shortcuts voice commands to control the connected automations.
 - Manage the devices remotely via smartphone, smartwatch or car infotainment with the Yubii or MyNice apps.
 - Protect your indoor environment from the heat of the sun, making the climate more comfortable and cutting back on use of air conditioning.

Fast programming

The limit switches can also be programmed from the transmitter by performing two complete manoeuvres, guaranteeing continuous automatic calibration during operation.

Two intermediate opening positions can be set. The desired partial opening can be programmed in relation to the sun sensor settings.

Compatible with unidirectional and bidirectional remote controls and climate sensors

Venetian blinds, rolling shutters and awnings can be controlled without the need for a gateway.

Efficient

Each bidirectional product acts as a radio signal repeater to extend signal coverage.

TECHNICAL SPECIFICATION

Code	Description	Pcs./pack	Certificates
BIDI-AWNING	Outdoor unidirectional and bidirectional interface for tubular motors	1	CE

Code	BIDI-AWNING
ELECTRICAL SPECIFICATIONS	
Power supply (VAC/Hz)	100–240, 50/60
Motor rated current (A)	2
Type of motor supported	single-phase AC
Recommended installation height (m)	2.4
Radio frequency (Mhz)	433.05–434.04
Max. transmit power (dBm)	10
Protection class (IP)	55
Operating temperature (°C Min/Max)	-20–+35
Dimensions (mm)	98 x 26 x 20 h



We imagined the freedom to explore the world and turned it into a house-system.

Connected, integrated and customisable.
Safe and easy to use. The smart home system is the Nice project that puts the way you want to live at the centre of the automation.

Even when you're busy exploring the world.

www.niceforyou.com

Nice SpA
Oderzo, TV, Italy

