

EN - Instructions for accessory BMA1

ISO098A01EN rev.00 14-09-2018

Nice

The use of the electric lock is mandatory

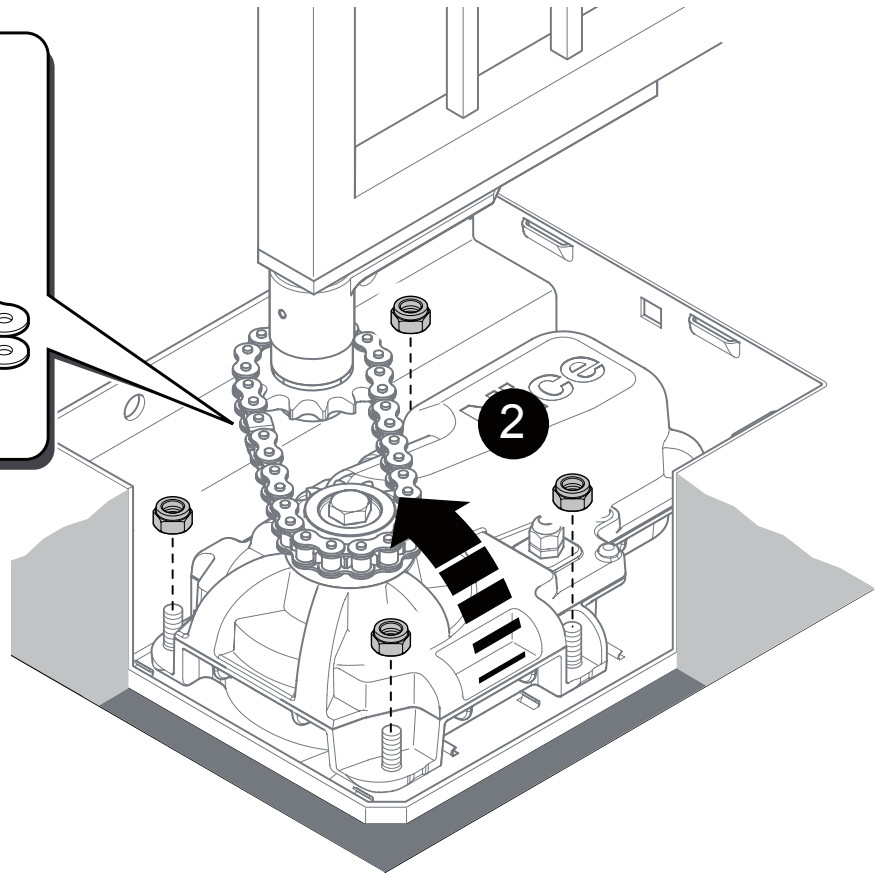
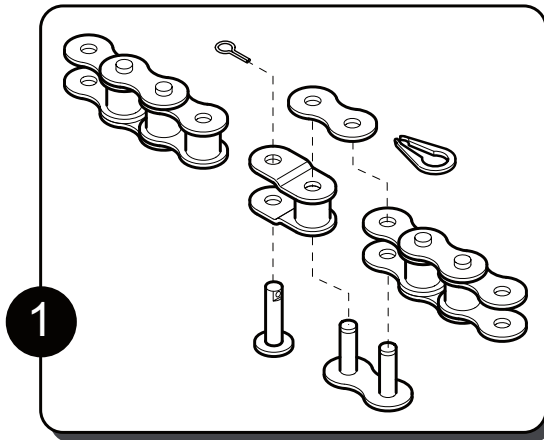

UTILISATION LIMITS

BMA1 with L-FAB: LFAB4000 or LFAB4024	400 kg - 3,5m
	300 kg - 2,5m (*)
BMA1 with BIG-FAB: BFAB5024	500 kg - 2,5m
	400 kg - 3,5m
	300 kg - 2,5m (*)

(*) in windy areas .