

# MhouseKit WK2

## ERRATA CORRIGE

### PAGE. 5

**Table 1: list of small parts for two WK1**

	units
8x45 carriage screw	2 pcs.
8x35 carriage screw	2 pcs.
8x30 carriage screw	8 pcs.
8x25 hex-head screws	2 pcs.
8 mm dia. flat washers	8 pcs.
M8 self-locking nuts	12 pcs.
8 mm dia. flat washers nylon	8 pcs.
8 mm dia. grower washers	2 pcs.
Plugs for slotted lever	2 pcs.
Adjustable brackets	2 pcs.

### PAGE. 10

9 Fasten the gearmotor to the plate with the screws [I], the 4 self-locking nuts and the washers [H]. Cover the back of the self-locking nuts with the nut covers [F] and the front with the release covers [G].

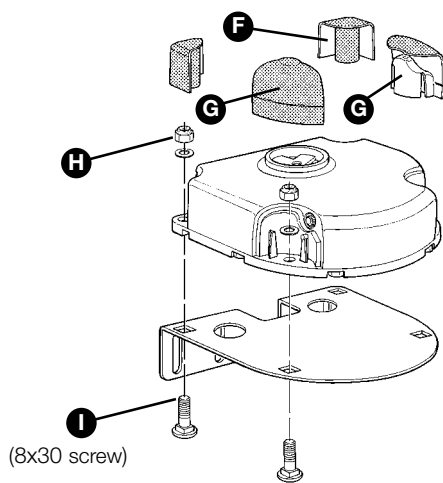

Figure 23

### PAGE. 10

12 Mount the curved arm and the fastening bracket on the leaf with the screws [A] [P1], the self-locking screws [R] and the nylon washers [Q]

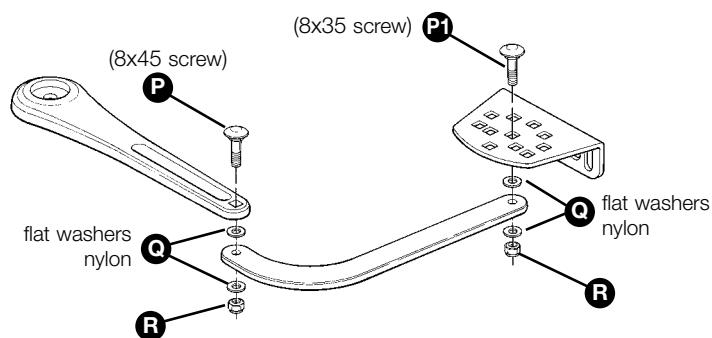

Figure 25

# MhouseKit WK2

## ERRATA CORRIGE

### PAG. 5

Tabella 1: Elenco minuteria per due WK1	Q.tà
Viti 8x45 testa tonda quadro sotto testa	Pz. 2
Viti 8x35 testa tonda quadro sotto testa	Pz. 2
Viti 8x30 testa tonda quadro sotto testa	Pz. 8
Viti 8x25 testa esagonale	Pz. 2
Rondelle piane Ø 8mm	Pz. 8
Dadi autobloccanti M8	Pz. 12
Rondelle piane Ø8mm nylon	Pz. 8
Rondelle grover Ø8mm	Pz. 2
Tappi per leva asolata	Pz. 2
Staffe di fissaggio regolabili	Pz. 2

### PAG. 10

9 Fissare il motoriduttore sulla piastra con le viti [I], i 4 dadi autobloccanti e le rondelle[H]. Coprire i dadi autobloccanti, nella parte posteriore con i tappi copridado [F] nella parte anteriore con i coperchi copri sblocco [G].



Figura 23

### PAG. 10

12 Assemblare il braccio curvo e la staffa di fissaggio all'anta utilizzando le viti [P] [P1], i dadi autobloccanti [R] e le rondelle in nylon [Q].

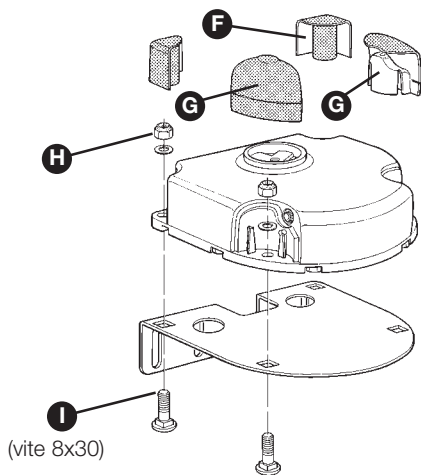

Figura 25

# MhouseKit WK2

## ERRATA CORRIGE

### PAGE. 5

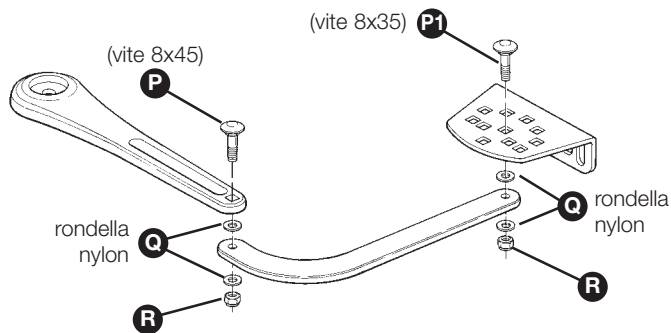
Tableau 1: Liste de la quincaillerie pour deux WK1	Q.tè
Vis 8x45 tête ronde carré sous tête	2 p.ces
Vis 8x35 tête ronde carré sous tête	2 p.ces
Vis 8x30 tête ronde carré sous tête	8 p.ces
Vis 8x25 à tête à six pans	2 p.ces
Rondelles plates Ø8mm	8 p.ces
Écrous indesserrables M8	12 p.ces
Rondelles plates nylon Ø8mm	8 p.ces
Rondelles grower Ø8mm	2 p.ces
Bouchons pour levier perforé	2 p.ces
Pattes de fixation réglables	2 p.ces

### PAGE. 10

9 Fixer l'opérateur sur la plaque avec les vis [I], les 4 écrous indesserrables et les rondelles [H]. Couvrir les écrous indesserrables, dans la partie arrière, avec les bouchons [F] et dans la partie avant avec les couvercles de protection du débrayage [G].

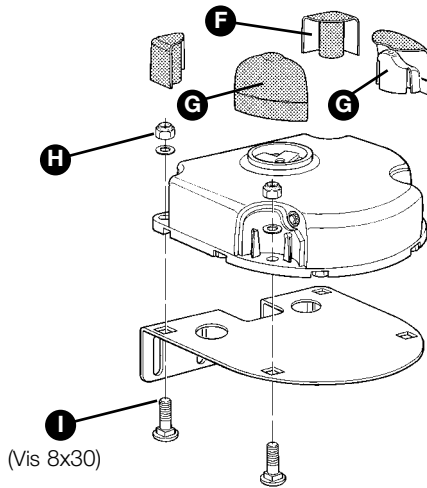

Figure 23

### PAGE. 10

12 Assembler le bras courbe et la patte de fixation au battant en utilisant les vis [P] [P1], les écrous indesserrables [R] et les rondelles en nylon [Q].

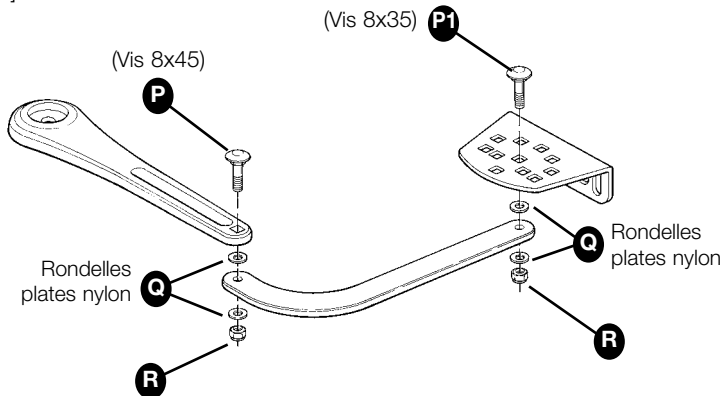

Figure 25